



# TOP LOAD WASHER QUICK CONNECT GUIDE

MAYTAG PUTS THE POWER IN YOUR HANDS





## STAY IN CONTROL & IN THE KNOW

GET ACCESS TO OPTIONAL SMART FEATURES  
WITH A CONNECTED SUBSCRIPTION\*

\*Appliance must be set to remote enable. WiFi & App required; Connected Subscription required in U.S. only. Features subject to change. Details & privacy info at [maytag.com/connect](https://maytag.com/connect) or [maytag.ca/connect](https://maytag.ca/connect) for residents of Canada.

## OPTIONAL SMART FEATURES\* OVERVIEW

### CONTROL AT YOUR FINGERTIPS

Manage laundry from anywhere so no load is left behind.



SCHEDULE A WASH CYCLE FOR LATER



CONTROL YOUR WASHER WITH A SMART VOICE ASSISTANT\*\*



TROUBLESHOOT ERROR CODES WITHOUT A TECHNICIAN



ASSIGN A TASK

### SUPPORT TO TACKLE TOUGH MESSSES

Tools to help you get the best clean and utilize the power of your Maytag® washer.



GET PERSONALIZED LAUNDRY TIPS



ACCESS SPECIALTY CYCLES FOR ANY LAUNDRY CHALLENGE



SAVE & START FAVORITE CYCLES FROM ANYWHERE



STAIN GUIDE†

*TO LEARN MORE ABOUT SMART FEATURES VISIT OUR [CONNECTED APPLIANCES PAGE](#)*

\*Appliance must be set to remote enable. WiFi & App required; Connected Subscription required in U.S. only. Details & privacy info at [maytag.com/connect](http://maytag.com/connect) or [maytag.ca/connect](http://maytag.ca/connect) for residents of Canada.

\*\*U.S. only. †Select stains only.

## HOW TO CONNECT

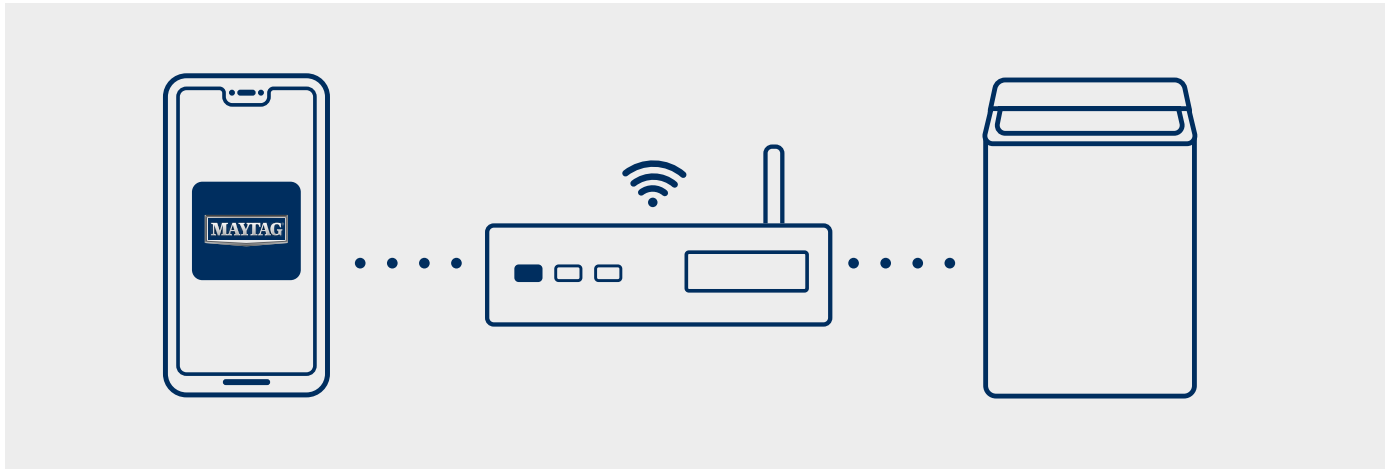

### SMART SETUP

Start by downloading the Maytag™ App on [Google Play](#) or the [App Store](#).  
Once downloaded, you're only three steps away from connecting your washer.

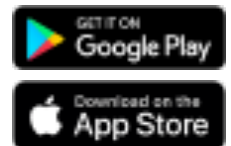

#### STEP 1:

Turn on your phone's Bluetooth setting and connect to the wireless network you want to use for your washer.



#### STEP 2:

Power on your washer, then press Remote Enable.

## HOW TO CONNECT

---

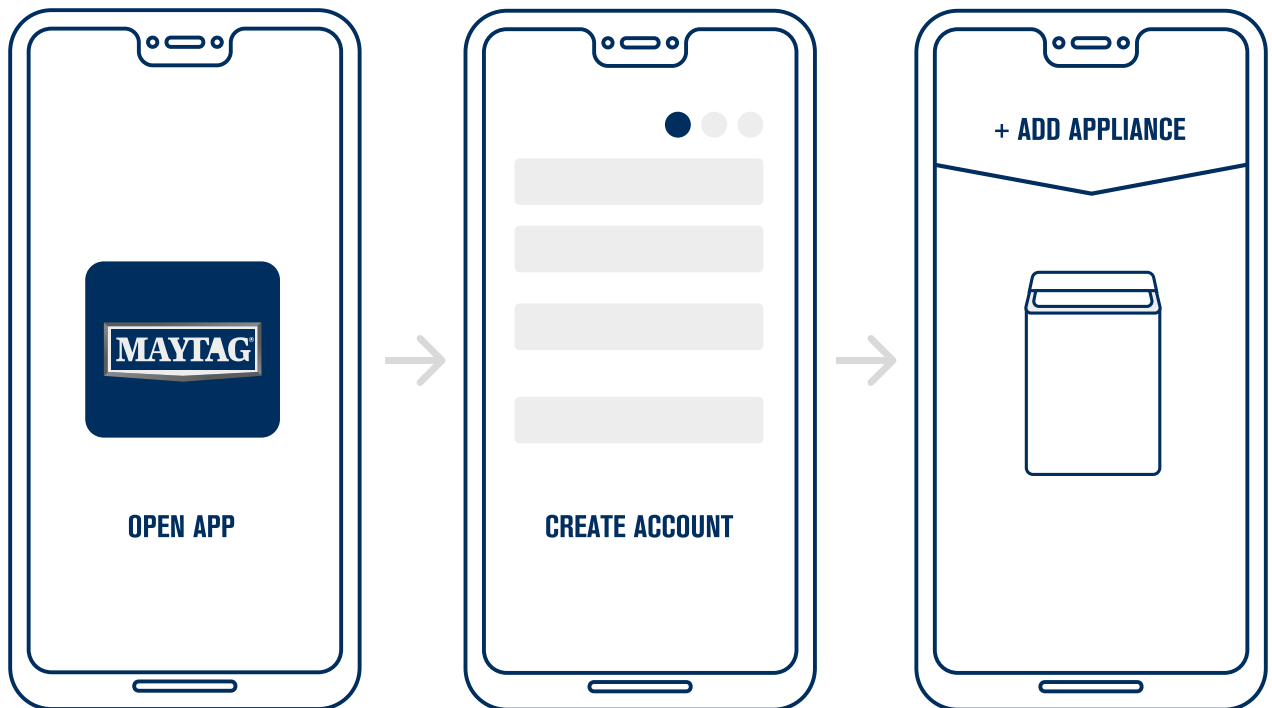

### STEP 3: CONNECT WITH THE APP

Open the Maytag™ App, tap Add Appliance, then select the washer and follow the guided steps to set up your subscription free trial and finish connecting your appliance.

## CONNECTION TIPS

---

### HAVING TROUBLE?

Here are some tips to help you get connected.

- CHECK TO SEE IF YOUR APPLIANCE IS IN THE CORRECT MODE, REMOTE ENABLED.
  - CHECK APP PERMISSIONS IN YOUR PHONE SETTINGS TO ENSURE BLUETOOTH AND LOCATION SERVICES ARE ENABLED.
  - POWER THE APPLIANCE OFF, THEN TURN IT ON AGAIN.
  - CHECK THAT YOUR WIFI ROUTER HAS A 2.4GHZ FREQUENCY BAND.
  - RETURN TO THE APP TO COMPLETE THE CONNECTION STEPS.
- 



DON'T FORGET TO PRESS THE "REMOTE ENABLE" BUTTON ON YOUR APPLIANCE EACH TIME BEFORE USING REMOTE START. REMOTE ENABLE RESETS WHEN THE LID IS OPENED.

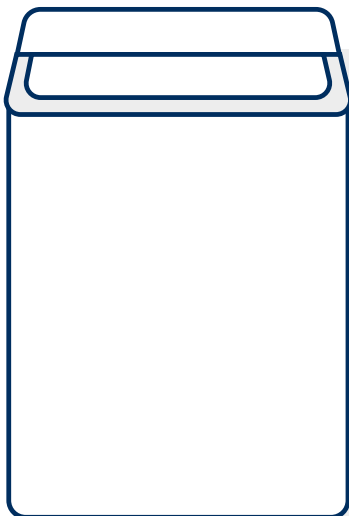

### **SIGN UP AND SUBSCRIBE TO THE MAYTAG™ APP (U.S. ONLY)**

Get all the benefits of smart technology in your top load washer with a connected subscription.

### **Models that require a connected subscription (U.S. only):**

MVW6230H, MVW6230RH, MVW7230H,  
MVW7232H, MVW8230H.

***SEE CONNECTED SUBSCRIPTION DETAILS***

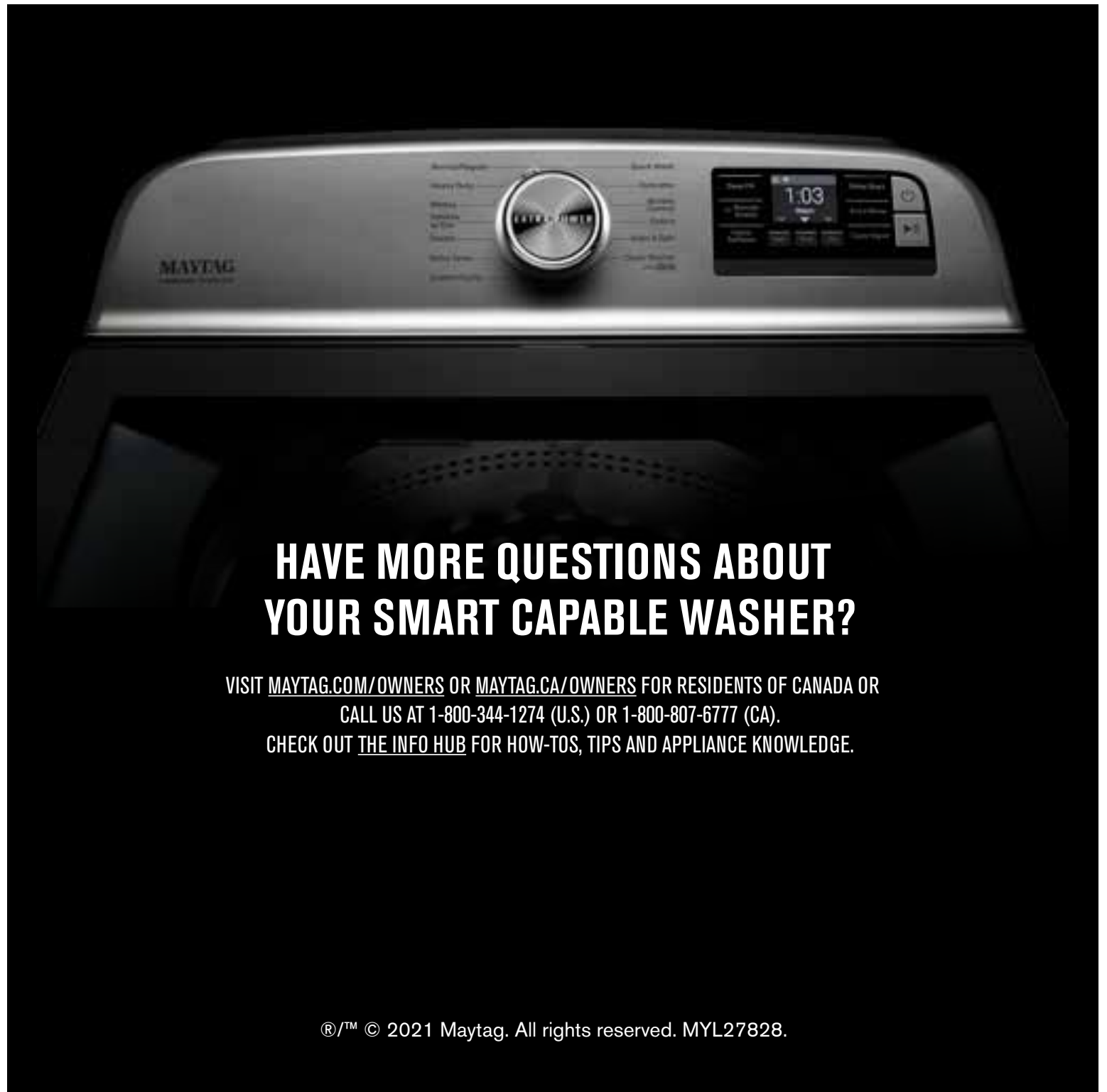

## HAVE MORE QUESTIONS ABOUT YOUR SMART CAPABLE WASHER?

VISIT [MAYTAG.COM/OWNERS](https://www.maytag.com/owners) OR [MAYTAG.CA/OWNERS](https://www.maytag.ca/owners) FOR RESIDENTS OF CANADA OR  
CALL US AT 1-800-344-1274 (U.S.) OR 1-800-807-6777 (CA).  
CHECK OUT [THE INFO HUB](#) FOR HOW-TOS, TIPS AND APPLIANCE KNOWLEDGE.

®/™ © 2021 Maytag. All rights reserved. MYL27828.